

### Special Features:

- Robust two piece design
- The diaphragm is welded to the body to ensure separation of the filling fluid from the process medium
- All SS construction

### Applications:

Diaphragm seals are designed to isolate the sensing element of pressure gauges and pressure switches from process fluids that they may be corrosive, viscous, sediments and / or with a high temperature.

### Specifications:

- Range: -1 Bar/Psi to 400 Bar/Psi ( Standard)
- Process Temperature : -40°C to 200°C or as per fill fluid
- Type D01
  - Instrument Connection : 1/2" BSP (F)
  - Process Connection: 1/2" NPT (M)
- Type D02
  - Instrument Connection: 1/2" NPT (F)
  - Process Connection: 1/2" NPT (F)
- Fill Liquid : Silicon Oil -DC 200
- Diaphragm: AISI 316L SS
- Top Chamber: AISI 316 SS
- Bottom Chamber: AISI 316 SS
- Nuts / Bolts :AISI 304 SS
- Sealing Gasket : PTFE max 250°/ Inconel silver plated for 400°C max



Type D01

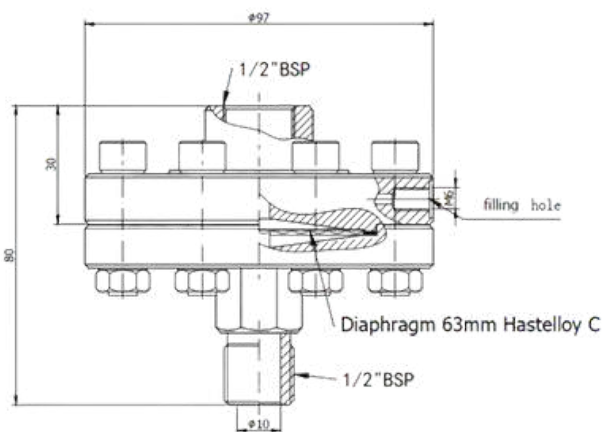

Type D02

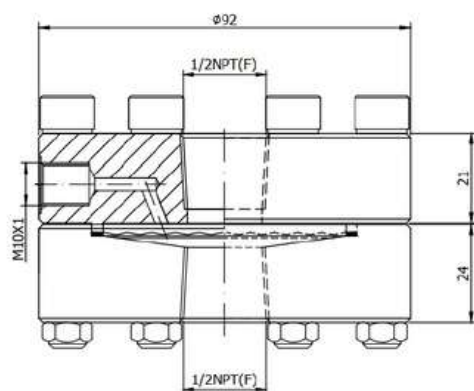

**HOW TO ORDER**

**BASIC MODEL**

D-01

**RANGE**

-1 to 0 Bar/Psi & 0 to 70Bar/Psi (Standard)      S07 100 Bar/Psi to 400Bar/Psi      XXX

**INSTRUMENT CONNECTION**

**VN** 1/4"BSP(F)    **VP** 3/8"BSP(F)    **VL** 1/2"BSP(F)    **VM** 1/2"NPT(F)(Standard)    **VO** 1/4"NPT(F)      XX

**TOP CHAMBER**

**XW** AISI 304 SS (Standard)    **YA** AISI SS316L SS    **XY** AISI 316 SS      XX

**DIAPHRAGM**

**UJ** AISI 316L SS (Standard)    **UL** HASTELLOY 'C'    **UR** TITANIUM    **UW** INCONEL 600      XX  
**UM** MONEL    **UP** SILVER\*    **UQ** TANTALUM    **UN** SUPER DUPLEX

**SEALING GASKET**

**VI** PTFE (Standard)    **YR** METAL    **YQ** Inconel Silver Plate for Max 400°C (High Temp.Oil)      XX

**BOTTOM CHAMBER**

**TK** AISI 304 SS    **TT** HASTELLOY 'C'      XX  
**TM** AISI 316 SS(Standard)    **UD** TANTALUM  
**TL** AISI 316L SS    **TZ** PVC\*  
**UH** TITANIUM    **UA** PVDF\*  
**TX** MONEL    **TY** POLYPROPELENE\*

MOC OF Bottom Chamber	PRESSURE V/S TEMPERATURE					
	20 °C	40 °C	60 °C	80 °C	100 °C	120 °C
PVDF	10 Bar/Psi	10 Bar/Psi	10 Bar/Psi	7 Bar/Psi	4 Bar/Psi	2 Bar/Psi
PP	10 Bar/Psi	10 Bar/Psi	6 Bar/Psi	4 Bar/Psi	1 Bar/Psi	NA
PVC	10 Bar/Psi	10 Bar/Psi	4 Bar/Psi	1 Bar/Psi	NA	NA

**PROCESS CONNECTION**

**WE** 1/4"BSP(F)    **WI** 1/4"NPT(F)    **WY** 1/4"NPT(M)    **WS** 1/4"BSP(M)    **WR** M20X1.5(M)      XX  
**WC** 3/8"BSP(F)    **WH** 1/2"NPT(F)    **WA** 1/2"NPT(M)(Standard)    **WT** 3/8"BSP(M)(Standard)    **WP** M33X1.5(M)  
**WD** 1/2"BSP(F)    **WL** 3/4"NPT(F)    **WK** 3/4"NPT(M)    **WU** 1/2"BSP(M)(Standard)  
**WJ** 3/4"BSP(F)    **WF** 3/4"BSP(M)

**PROTECTION ON WETTED PARTS**

**VS** PTFE LINING ON BOTTOM CHAMBER -2mm THICK (Max.Up to 150°C)      XX  
**VV** PTFE PROTECTION FOR DIAPHRAGM (Max.Up to 150°C max up to 100 bar)  
**VZ** PTFE COATING ON DIAPHRAGM (Max.Up to 315°C)

**FILLING LIQUID**

**US** FLUOROLUBE 4.2 [-45 to 175°C]    **UX** SILICON DC 200[-40 to 205°C];(Standard)    **VB** SYLTERM XLT [-100 to 260°C]      XX  
**UT** FLUOROLUBE 6.3 [-40 to 235°C]    **UY** SILICON DC 704 [10 to 337°C]    **VC** HALOCARBON OIL\*  
**UU** FLUOROLUBE FS-5 [-28 to 148°C]    **UZ** SILICON DC 710 [7 to 371°C]    **VD** LRS9 [-40 to 400°C]  
**UV** FOOD GRADE OIL [-20 to 140°C]    **VA** SYLTERM 800 [-40 to 315°C]

**REMOTE MOUNTING (With Capillary of Max. Up to 15 Mtrs.)**

SPECIFY IN METERS (e.g 1.5=1.5 METERS 2.0=2 METERS)      3Mtr.

**CAPILLARY**

**PE** AISI 304 SS    **PG** AISI 316 SS      XX

**CAPILLARY COVERED WITH ARMOUR**

**PF** AISI 304 SS    **PH** AISI 316 SS    **PI** PVC      XX

**OTHER OPTIONS**

**TB** HELIUM LEAK TEST    **TC** DRY SEAL ONLY WITHOUT INSTRUMENT    **GH** MATERIAL TEST CERTIFICATE\*      XX

**Ordering Example: D-01-XXX-XX-XX-XX-XX-XX-XX-XX-3 Mtr-XX-XX-XX**