

Special Features:

- Polypropylene case with SS measuring system
- Wetted parts AISI 316l stainless steel
- Solid front design features baffle wall interposed between the sensing system, the window and a pressure
- Relieving back for increased safety
- Standard followed ANSI/ASME - B 40.1

Applications:

Suitable for high pressure gas, corrosive/hazardous environment that will not obstruct the pressure system.



Standard Version:

Nominal size: 115 mm (4 1/2")

Accuracy class	Grade 2A to ANSI B40.1 (0.5%)
Scale ranges	0...0,6 to 0...1600bar or equivalent other units of pressure or vacuum
Ambient temperature	- 40°C to + 65°C
Process temperature	Max 200°C
Over pressure limit	≤ 100 bar : 125% of Max. scale value > 100 to ≤ 600 bar : 115% of Max. scale value > 600 to ≤ 1600 bar : 110% of Max. scale value
Case & ring	Fibre glass reinforced polypropylene
Bourdon	AISI 316L SS (-1 to 60 bar C type 100 to 1600 bar helical type)
Socket	AISI 316L SS
Movement	AISI 304 SS
Joints	Tig argon arc welding
Protection	IP65 - EN 60 529/ IEC 529
Dial	Aluminium, black graduation on white background
Pointer	Aluminium, black coloured, micrometer zero adjustable
Window	Plexi glass
Blow off disc	AISI 304 SS
Gasket	Neoprene

DRY BUT FILLABLE VERSION

Fillable dampening liquid Glycerine 98%
Process temperature Maximum 200°C

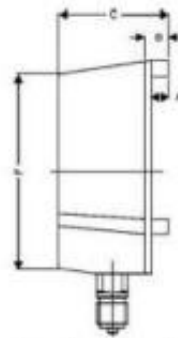
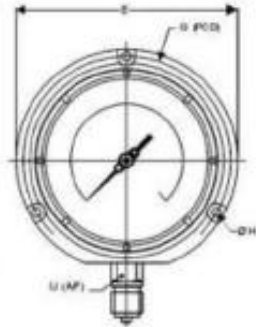

TYPE A

- Notes :
- Drawings are not to scale.
 - All Dimensions are in mm.
 - NS = Nominal Size
 - H - Arrangement for Mounting type 1

NS	A	B	C	E	F	G	H	U	Weight in gram (with BOX)
115	12.5	24.5	73.5	148	130	137.5	8	22	900.00

HOW TO ORDER

- Basic Model
- Code
- Nominal Size
- Type Of Mounting
1 Wall / Surface / Projection Mounting With Bottom Entry
- Gauge Connection

3BM	3/8" BSP (M)
4BM	1/2" BSP (M) Standard
2NM	1/4" NPT (M) Standard
4NM	1/2" NPT (M) Standard

Note : Connections like Metric/PT/PF/Flaired/UNF/G/R etc can be provided on request.

- Range - Refer Range Table

Optional Extras

- | | |
|---|--|
| <ul style="list-style-type: none"> OB Accuracy 1.0% Of FS. TI Monel Bourdon & Socket (Monel Version)** PW Five Point Calibration Certificate PU Calibration Certificate Traceable To National/ International Standards RH Custom Designed Dial SG Oxygen Service SW Dial Tag Marking SX SS Tag Plate TB Heliumleak Test ST Fibre Glass Reinforced Polypropylene Bod. SD Aisi316 Ss Movement | <ul style="list-style-type: none"> RX Shatterproof / Safety Glass TF Tested To Nace Standards FS Fillable Liquid Silicon Oil* FG Fillable Liquid Glycerine SF Movement With Dampening Jelly QB Integral Dampening Screw (Aisi 316 Ss) FL Integral Dampening Screw (Monel)** PZ Dampening Liquid Mineral Liquid Filled PX Dampening Liquid Flourolube Filled PY Dampening Liquid Glycerine Filled QA Dampening Liquid Silicon Oil Filled* ZI Over Range Protection 150% Of FS. GH Material Test Certificates*** |
|---|--|

*Gasket & Filling plug of NBR. Consult factory for Viton.

**Integral Dampening Screw will Be In Monel If Ordered. Refer Option FL

***Material Test Certificate will be provided for wetted parts only with chemical composition testing