

### Special Features:

- CE Approved Electrical Contacts
- Stainless Steel Case & Measuring System
- Filled Version Available
- Standard Followed in General EN837-1

### Applications:

To Control the electrical operation of compressors, Pumps, Motors, Presses, Hydraulic & Pneumatic Equipments, Chemicals & Petrochemical Plants.



### Standard Version:

- Nominal Size: 100mm
- Scale Ranges: 0.....1. 0 to 0.....1600 bar or other equivalent unit of pressure of vacuum

Accuracy Class	1.6%
Ambient Temperature	-20 °C to +65 °C
Process Temperature	Maximum 100 °C
Electrical Wiring	DIN Connector
Contact Setting	Over on arc of 270: through a knob placed on Front lens
Operating Pressure Range	75% of scale value
Over Pressure Limit	Not Suitable
Case & Bezel	AISI 304 SS (Bayonet Type)
Bourdon	AISI 316L SS
Socket	AISI 316L SS (Directly welded to case)
Movement	AISI 304
Joints	Tig argon arc welding
Protection	IP65
Dial	Aluminum, black graduation on white background
Pointer	Aluminum, black colored fixed
Window	Plexi glass
Contact	Silver-nicked
Blow off disc	Neoprene
Gasket & Filling Plug	Neoprene

**FILLED VERSION (OPTION ZZ)**

Accuracy Class	1.6%
Ambient Temperature	Maximum 65 °C
Process Temperature	+15 ° C to 100 °C
Window	Plexi glass
Blow Off Disc*	NBR
Gasket & Filling Plug*	NBR
Dampening Liquids	Dielectric Oil
Other Features	Refer specification of standard version

**DIMENSION – STANDARD VERSION**

TYPE A

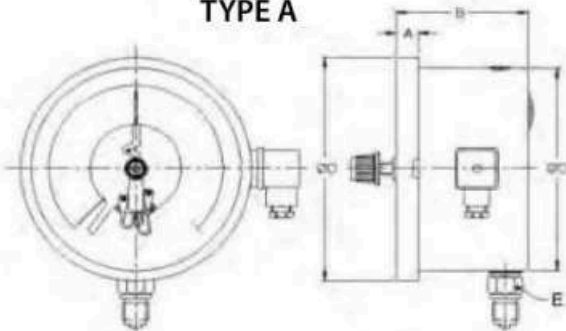

NS	A	B	OC	OD	E	Weight in gram (With Box)
100	12.5	90	100	111	A/F 22	840.0

Notes : • Drawings are not to scale. • All Dimensions are in mm. • NS = Nominal Size.

TYPE C

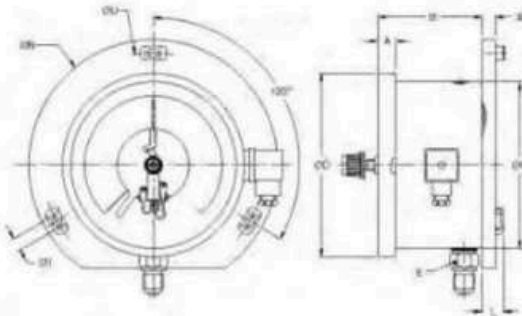

NS	A	B	OC	OD	E	OI	ON	OU	L	S	Weight in gram (With Box)
100	12.5	90	100	111	A/F 22	6	134	118	15	6	920.0